

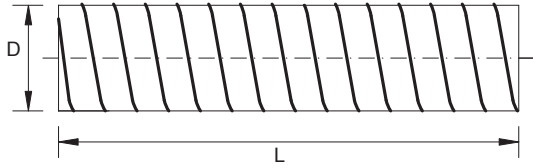

## Table of Contents

<b><u>Names</u></b>	<b><u>Pages</u></b>
Product designations and standards	1
Couplings	4
180° Crosses	5-7
Elbows	2-3
End Caps	4
45° Laterals	8
Offsets	10
Reducers	4
Register Boxes	9
Saddle Taps	9
Square to Round Fittings	10
90° Tees	5-7, 10
Volume Dampers	9
Y-Branches	10
SPIRAMir™ O-Ring Specification	11

## Product designations and standard gauges



D.....Nominal diameter (pipe size)  
 d<sub>1</sub>,d<sub>2</sub>,d<sub>3</sub>,d<sub>4</sub>.....Nominal diameter (fitting size)  
 L.....Installed length  
 L<sub>b</sub>.....Branch installed length  
 L<sub>r</sub>.....Reducer length  
 S.....Slip length  
 H.....Installed height  
 R.....Center line radius

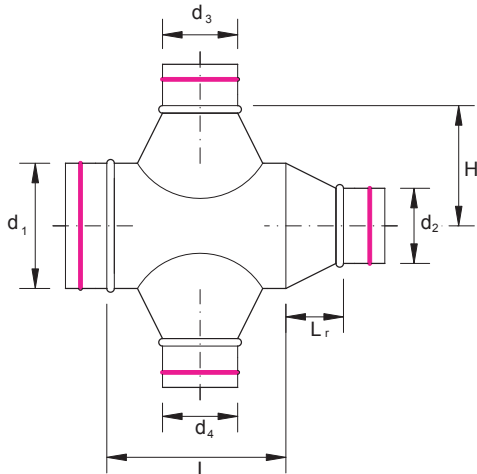
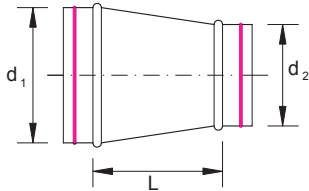
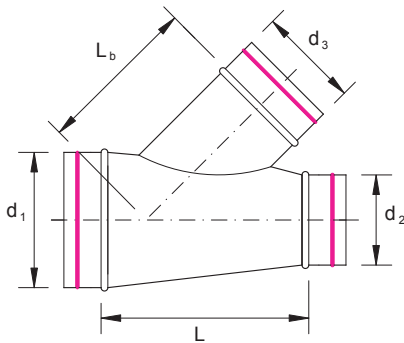

Galvanized Steel (ASAM A-527) or Stainless Steel (Type 304 or 316) Gauges for +10" W.G.		
Diameter	Spiral Pipe	Fitting/ Rolled Pipe
4"-14"	26	24
16"-26"	24	22
28"-36"	22	20
38"-48"	20	20

Aluminum (Type 3003-H14) Gauges for +2" W.G.		
Diameter	Spiral Pipe	Fitting/ Rolled Pipe
4"-14"	.025	.032
16"-26"	.032	.040
28"-36"	.040	.050
38"-48"	.050	.063

Polyvinyl Coated (PVC Coated) Steel Gauges					
4X1 Underground			4X4 or 4X1 Reverse Abovefloor		
Diameter	Spiral Pipe	Fitting/ Rolled Pipe	Diameter	Spiral Pipe	Fitting/ Rolled Pipe
4"-8"	26	26	4"-12"	26	26
9"-16"	24	24	14"	26	24
18"-24"	22	22	16"-18"	24	24
26"-32"	20	20	20"-26"	24	22
			28"	22	22
			30"-36"	22	20

All measurements are in inches (")  
 All angles are in degrees (°)

Sizes 4" thru 12"  
90° Die-Stamped Elbow

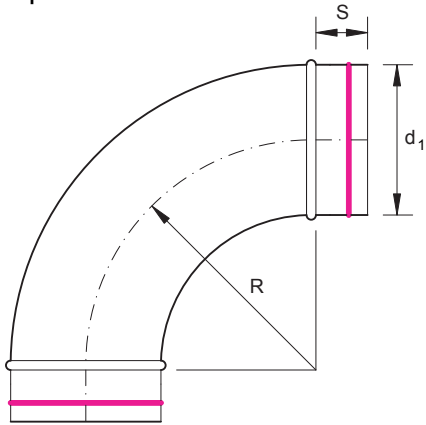

SAED90  
 $R=1.5Xd_1$

Sizes 4" thru 12"  
45° Die-Stamped Elbow

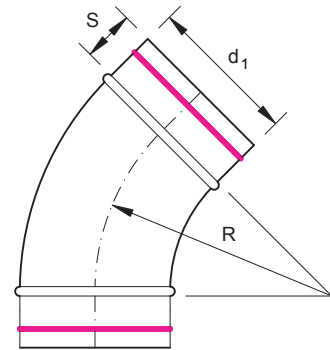

SAED45  
 $R=1.5Xd_1$

90° 5-Piece Elbow

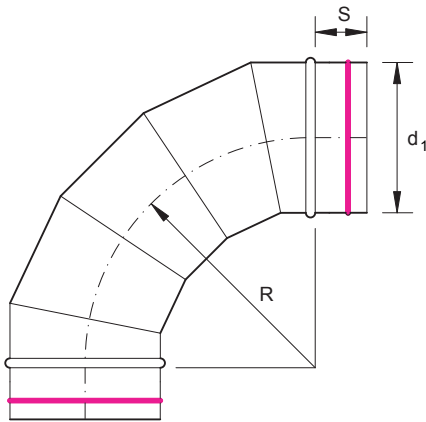

SAE590  
 $R=1.5Xd_1$

45° 3-Piece Elbow

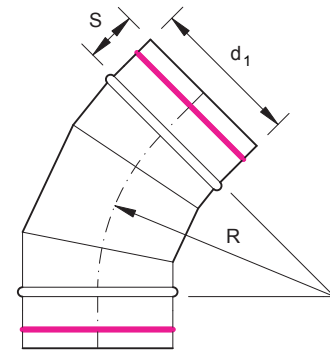

SAE345  
 $R=1.5Xd_1$

75° or 60° 4-Piece Elbow

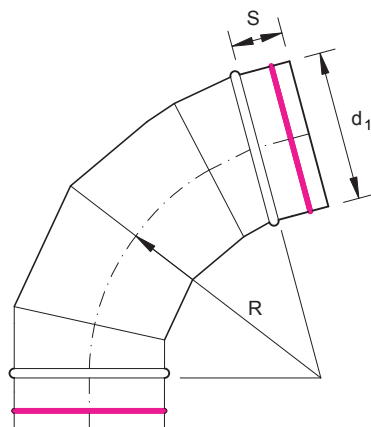

SAE475 OR SAE460  
 $R=1.5Xd_1$

30° or 22.5° 2-Piece Elbow

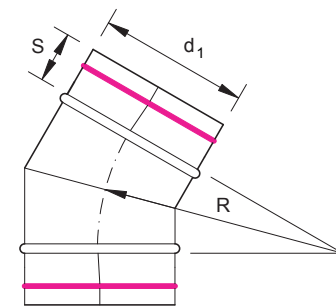

SAE230 OR SAE222.5  
 $R=1.5Xd_1$

## 90° 4-Piece Elbow

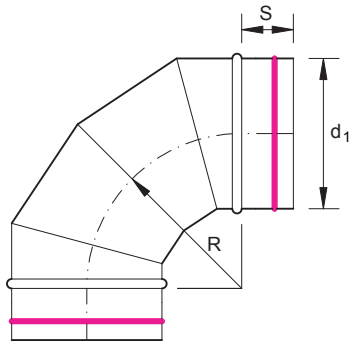

SAF490  
 $R=1.0Xd_1$

## 75° or 60° 3-Piece Elbow

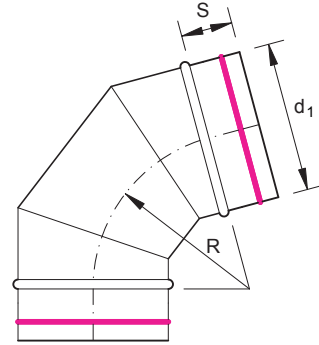

SAF375 OR SAF360  
 $R=1.0Xd_1$

## 45° 2-Piece Elbow

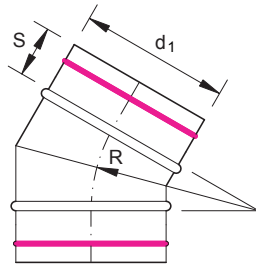

SAF245  
 $R=1.0Xd_1$

## 30° or 22.5° 2-Piece Elbow

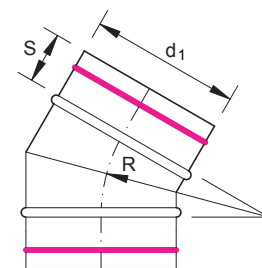

SAF230 OR SAF222.5  
 $R=1.0Xd_1$

## 90° 3-Piece Elbow with Take-Off

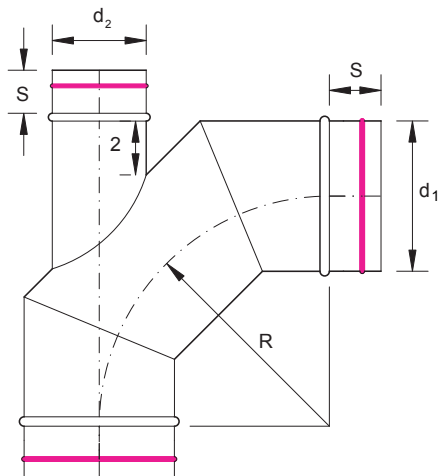

SAET90  
 $R=1.5Xd_1$

## 45° 2-Piece Elbow with Take-Off

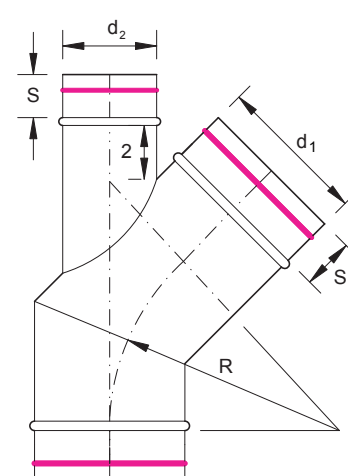

SAET45  
 $R=1.5Xd_1$

90° 2-Piece Mitered Elbow with or without Turning Vanes

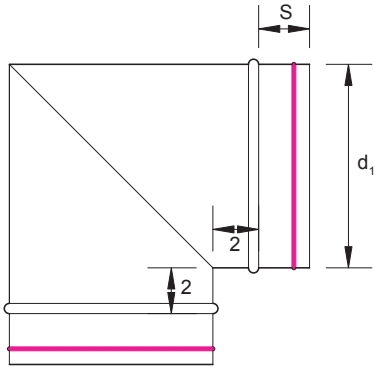

SAEM90

End Cap for Pipe

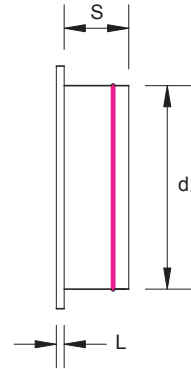

SAECP

End Cap for Fitting

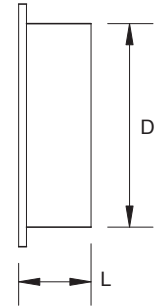

SAECF

Coupling for Pipe

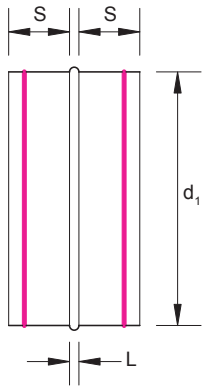

SAPC

Coupling for Fitting

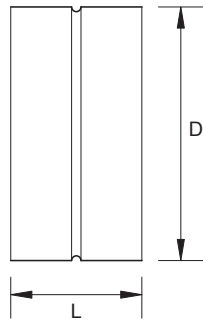

SAFC

Start Collar

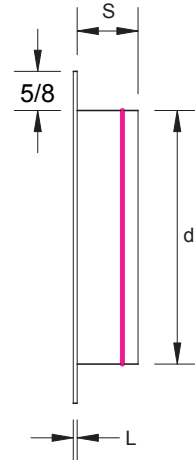

SASC

Bellmouth

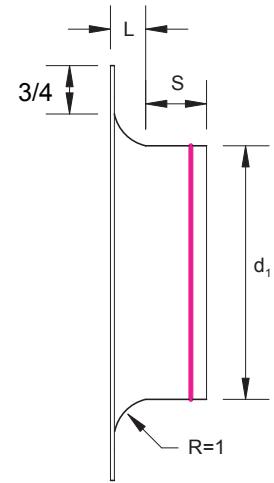

SABELL

Concentric Reducer

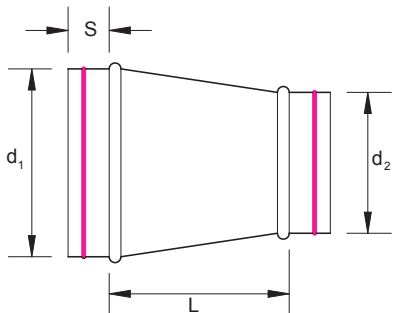

SACR

Eccentric Reducer

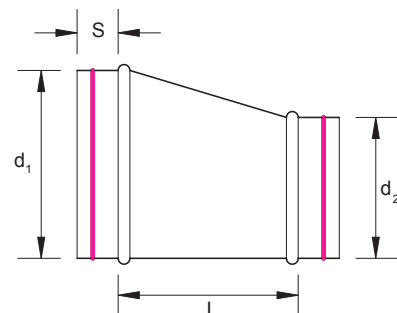

SAER

90° Tee

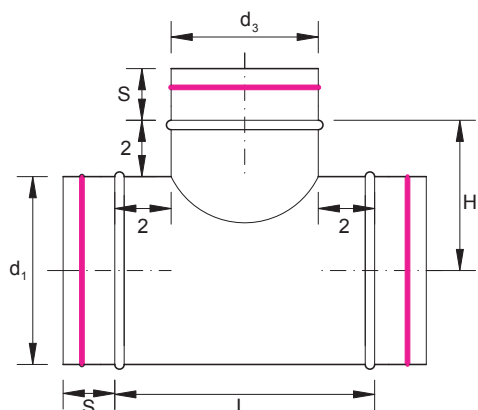

SAT90

180° Cross

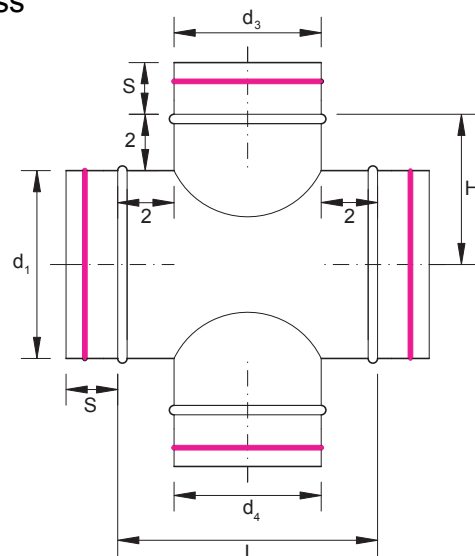

SAC180

90° Reducing Tee

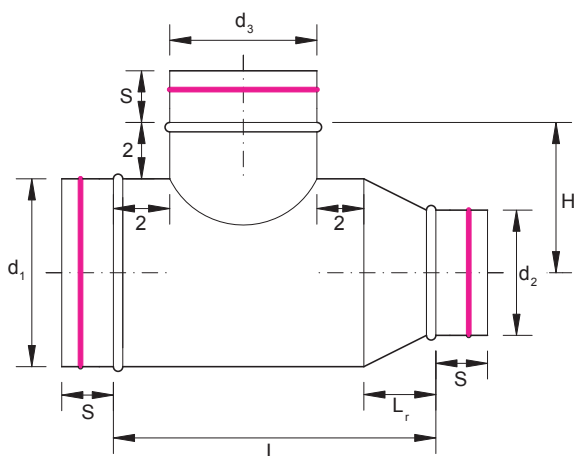

SAT90R

180° Reducing Cross

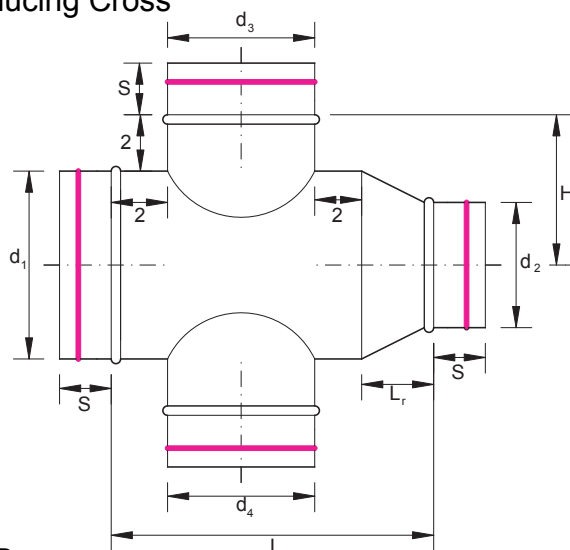

SAC180R

90° Reducing Body Tee

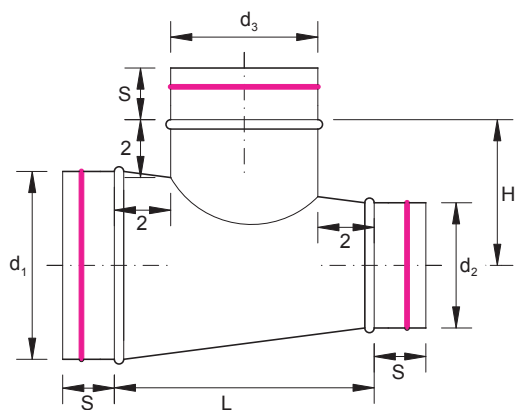

SAT90RB

180° Reducing Body Cross

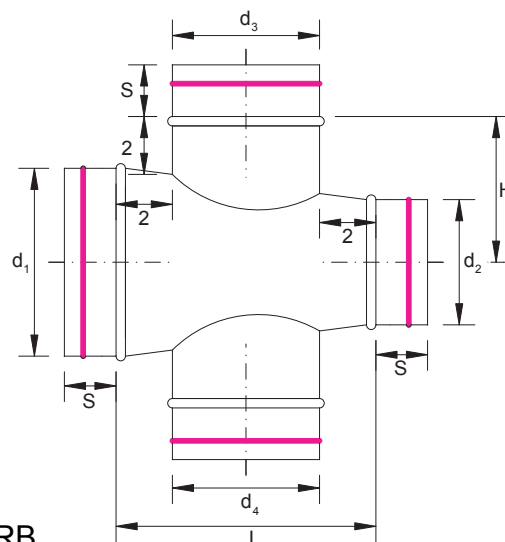

SAC180RB

90° Conical Tee

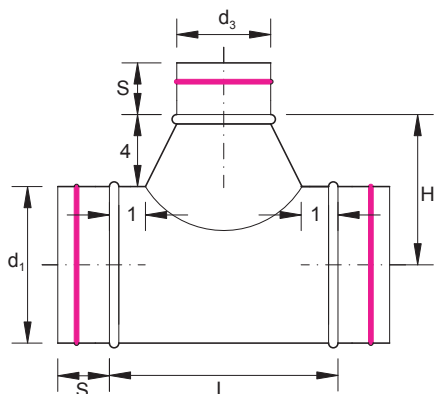

SACT90

180° Conical Cross

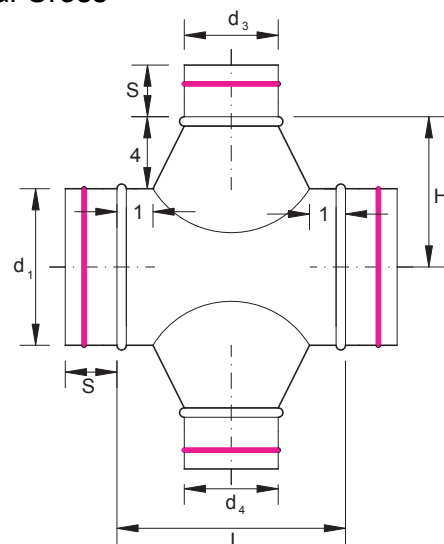

SACC180

90° Reducing Conical Tee

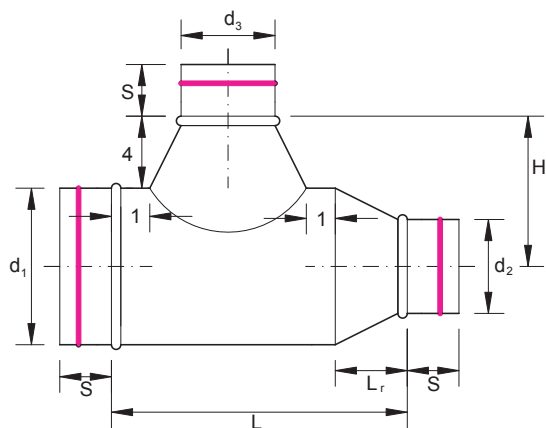

SACT90R

180° Conical Reducing Cross

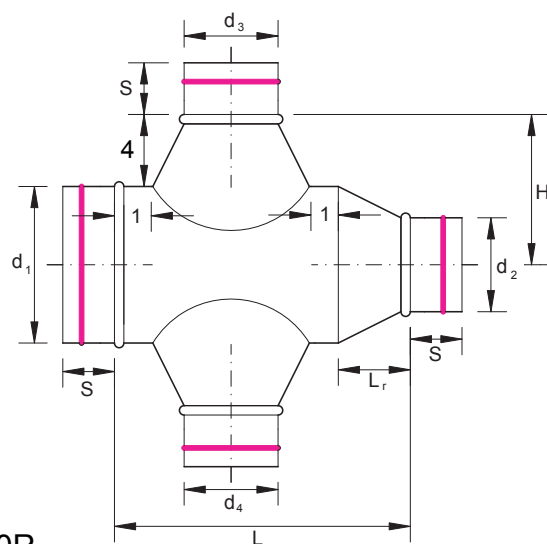

SACC180R

90° Reducing Body Conical Tee

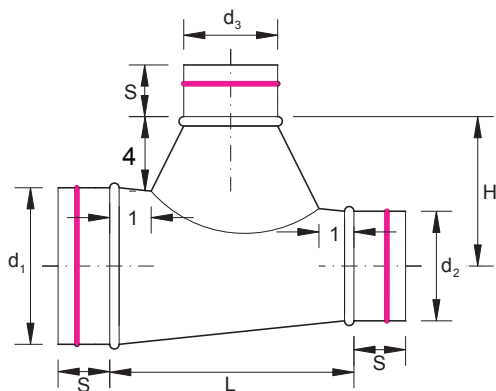

SACT90RB

180° Reducing Body Conical Cross

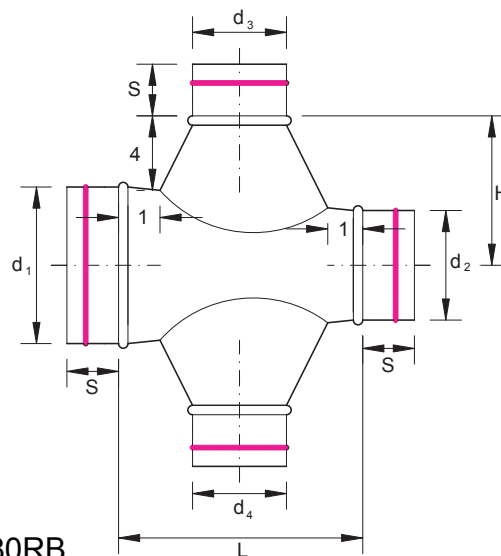

SACC180RB



45° Lateral

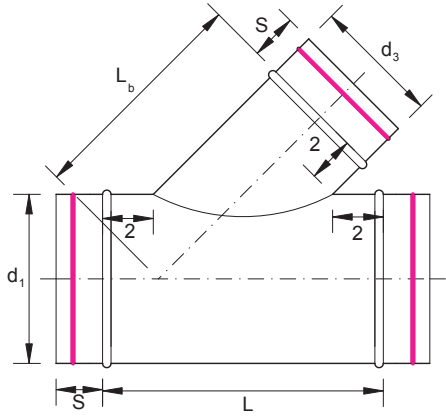

SAL45

45° Lateral Cross

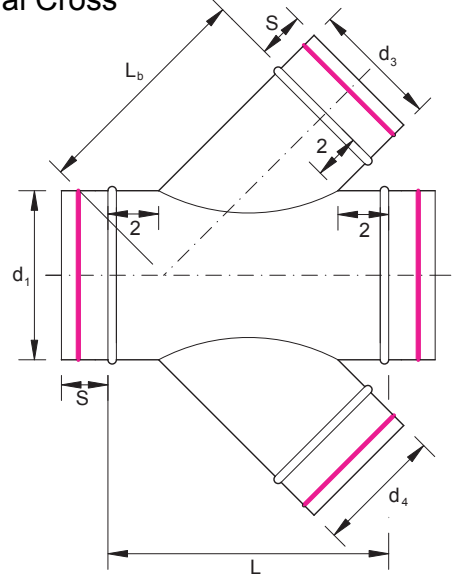

SALC45

45° Reducing Lateral

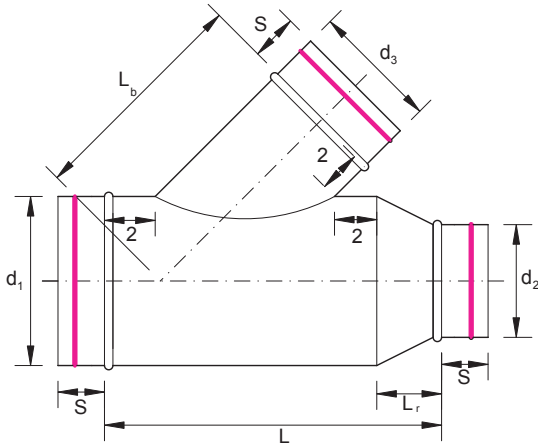

SAL45R

45° Reducing Lateral Cross

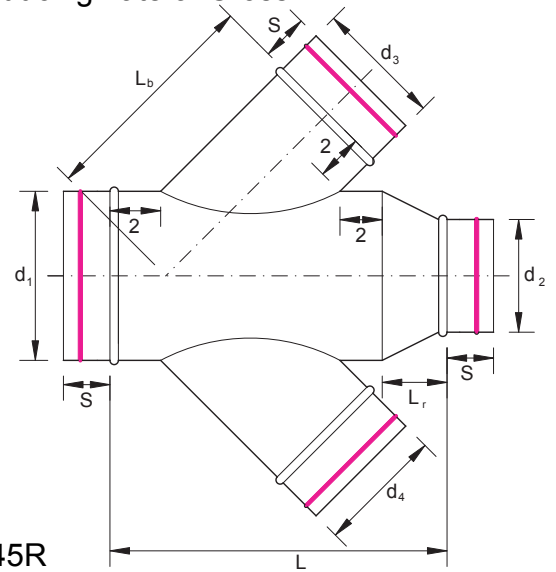

SALC45R

45° Reducing Body Lateral

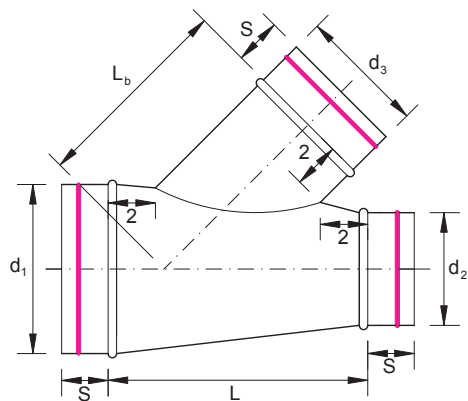

SAL45RB

45° Reducing Body Lateral Cross

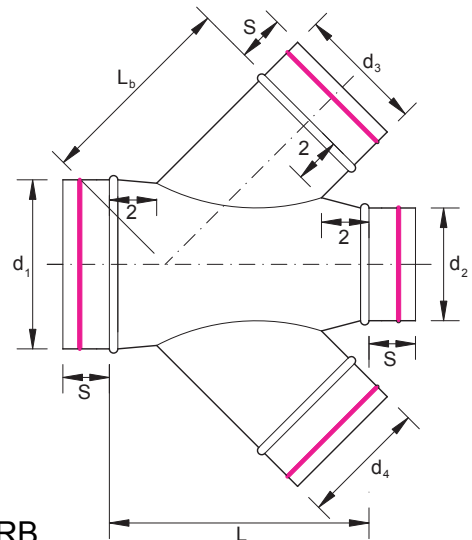

SALC45RB

Shoe Type 90° Tee

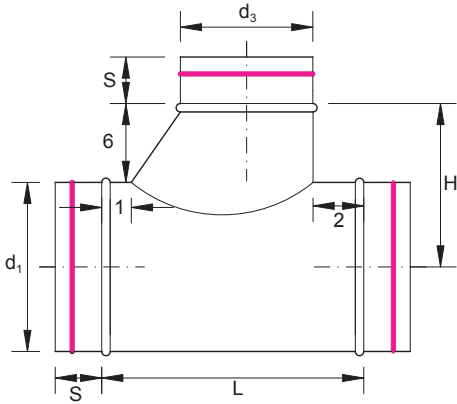

SASTT90

Shoe Type 180° Cross

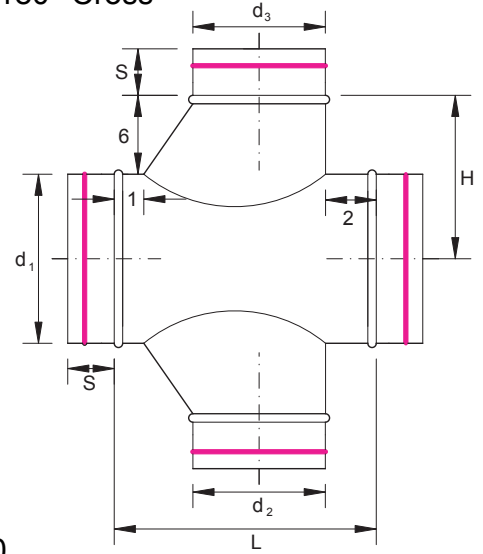

SASTC180

Shoe Type 90° Reducing Tee

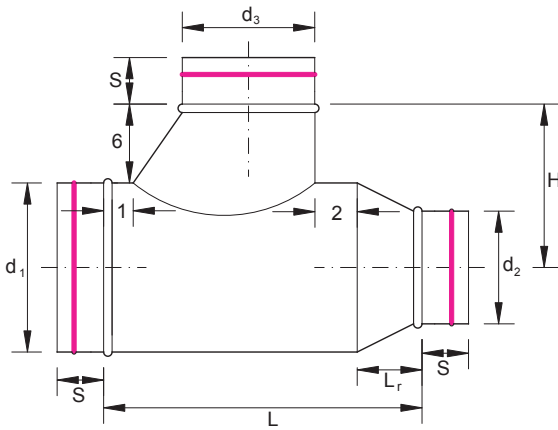

SASTT90R

Shoe Type 180° Reducing Cross

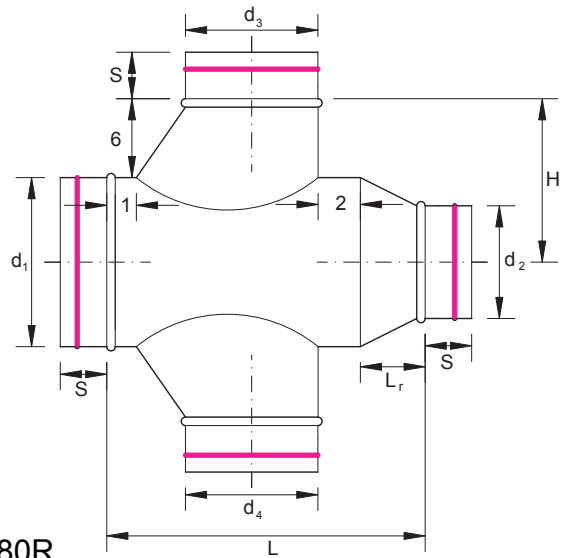

SASTC180R

Shoe Type 90° Reducing Body Tee

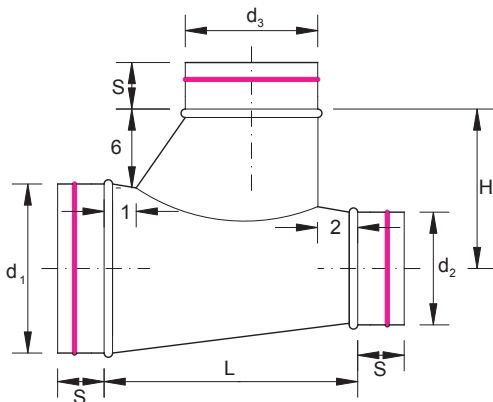

SASTT90RB

Shoe Type 180° Reducing Body Cross

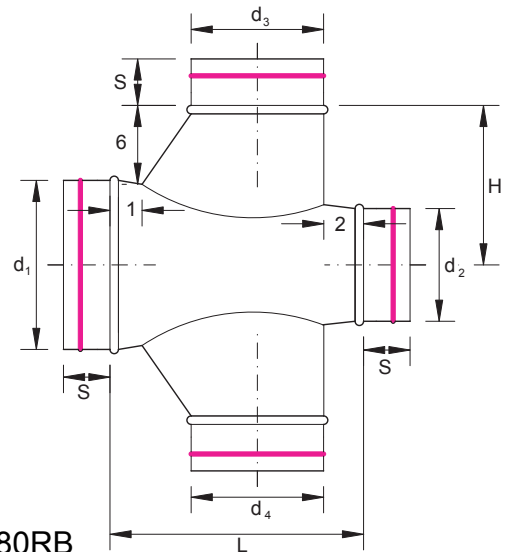

SASTC180RB

90° Saddle Tap

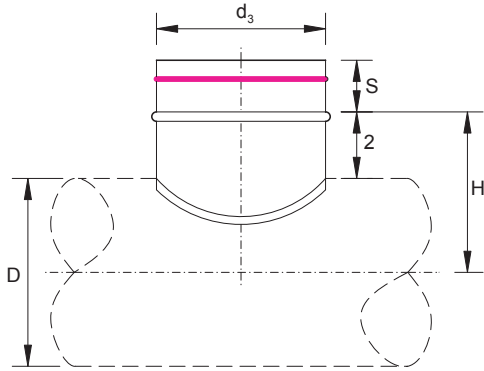

SATAP90

45° Saddle Tap

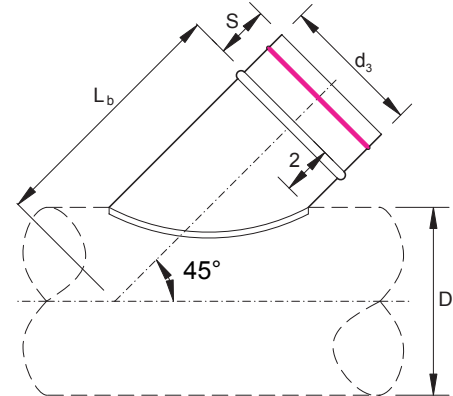

SATAP45

90° Conical Saddle Tap

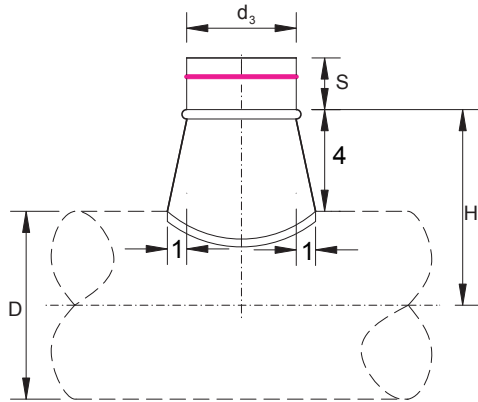

SACTAP90

90° Shoe Type Saddle Tap

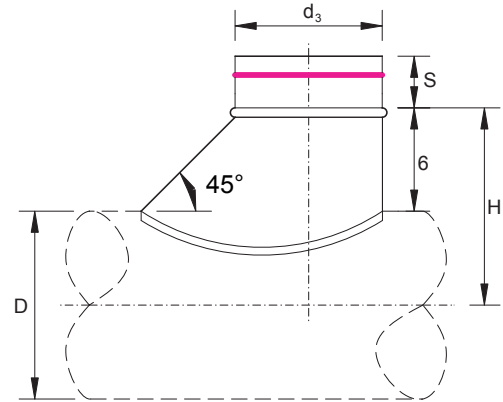

SASTAP90

Register Box

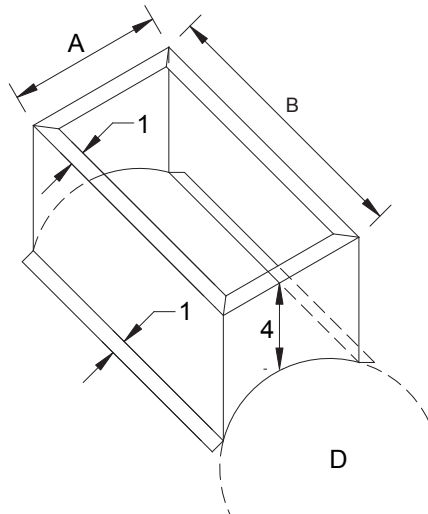

SARB

Volume Damper

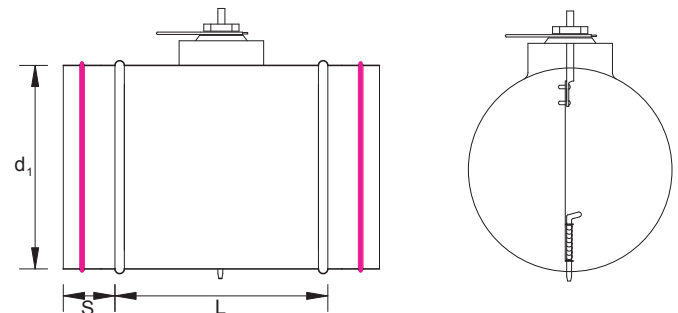

SAVD

Offset

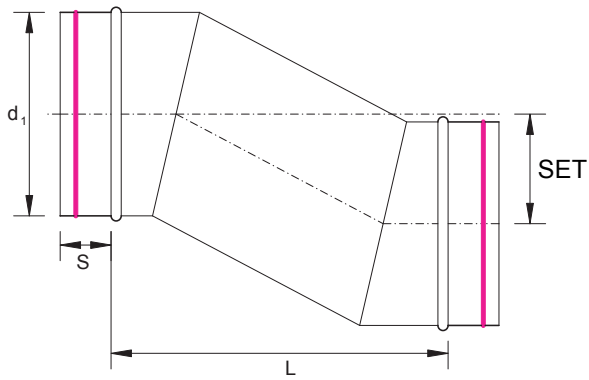

SAOFF

Square to Round

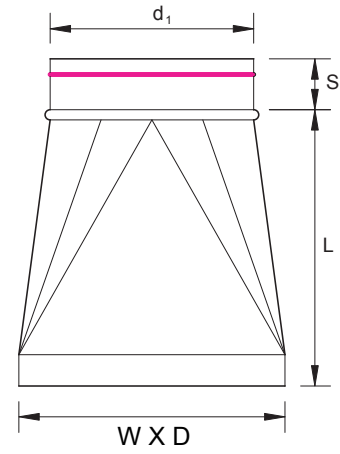

SASQRD

Y-Branch

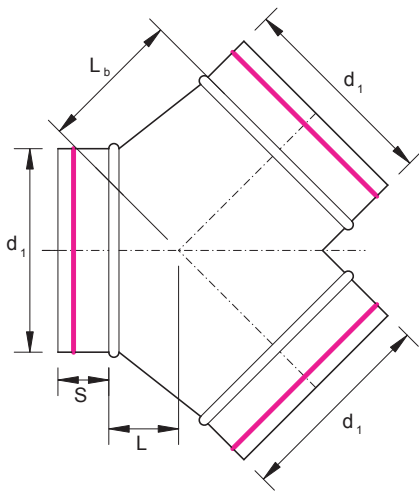

SAY

Reducing Y-Branch

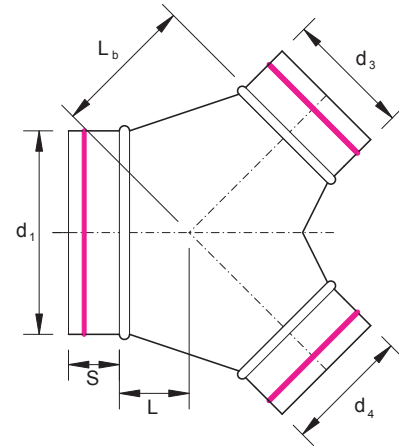

SAYR

Bullhead Tee

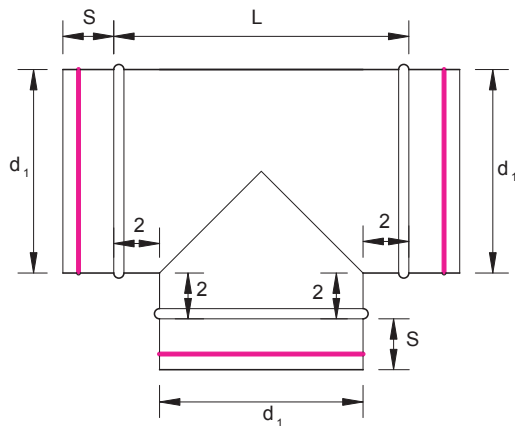

SABH

Reducing Bullhead Tee

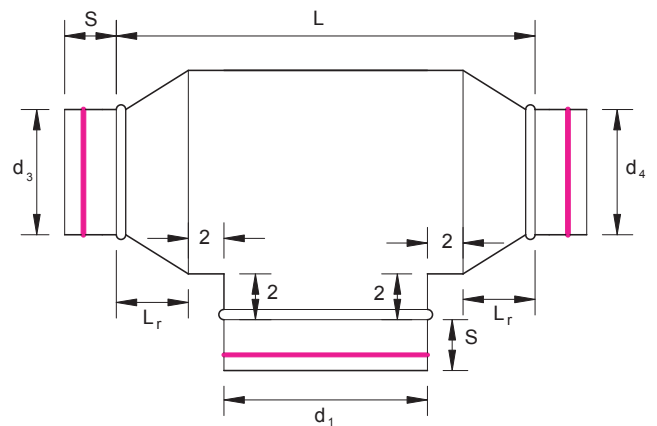

SABH-R

## **SPIRAmir™ O-Ring Specification**

**SPIRAmir™** O-Ring gasket is made from EPDM blend sponge rubber cord and has the following specifications:

- Excellent resistance to ozone, weathering, heat aging, UV exposures, compression set, water absorption and degradation by water aqueous systems and non-petroleum fluids
- Excellent flexibility at both low and high temperatures
- Excellent resistance to Acids & Alkalis
- Good resistance to fuels and oils

### **SPIRAmir™ Flame Spread and Smoke developed Indexes**

**SPIRAmir™** Self-Sealing Spiral Duct System has been tested by an accredited testing laboratory in accordance with UL testing standards. The results indicate that when testing in accordance with UL 723 and NFPA 255 standards, **SPIRAmir™** Spiral Duct System produces a flame spread index of zero (0) and smoke developed index of zero (0).